

**Plan Information**

Tenure Type	Freehold
Plan Type	Deposited Plan
Plan Purpose	Subdivision

**Plan Heading**

Lots 1-9, 9000 and Road Widening

**Locality & Local Government**

Locality	Beeliar
Local Government	City of Cockburn

**Department of Planning, Lands and Heritage**

File Number	
-------------	--

**Examination**

Examined	Date
----------	------

**Planning Approval**

Planning Authority	Western Australian Planning Commission
Reference	155966

Delegated under S. 16 P&D Act 2005	Date
------------------------------------	------

**In Order For Dealings**

Subject To	
------------	--

For Registrar of Titles	Date
-------------------------	------

**Plan Approved** Reg. 26A (4)

Inspector of Plans and Surveys / Authorised Land Officer	Date
--	------

**Survey Details**

Field Records	143792
Declared as Special Survey Area	Yes

**Survey Method Regulatory Statement**

Survey carried out under Reg. 26A Special Survey Area Guidelines. See survey sheet(s) to determine the true final position and type of all survey marks placed for this plan.

**Survey Method and Plan Content Variations**

Approved Variation Type	Reference
-------------------------	-----------

**Survey Certificate - Regulation 54**

I, Kenny R.SELLERS  
 hereby certify that this plan is accurate and is a correct representation of the -  
 (a) survey; and  
 (b) calculations from measurements recorded in the field records,  
 undertaken for the purposes of this plan and that it complies with the relevant  
 written law(s) in relation to which it is lodged.

**FINAL**

Licensed Surveyor	Date
-------------------	------

**Survey Organisation**

Name	MNG MCMULLEN NOLAN GROUP
Address	PO Box 3526, SUCCESS W.A. 6964
Phone	6436 1599
Fax	6436 1500
Email	info@mngsurvey.com.au
Reference	101335dp-003c

**Amendments**

Version	Lodgement Type	Amendment Description	Authorised By	Date
---------	----------------	-----------------------	---------------	------

**Former Tenure**

New Lot / Land	Parent Plan Number	Parent Lot Number	Title Reference	Subject Land Description
1-9	P 3562	Pt Lot 102	2855/1000	
9000	P 3562	Lot 97	2855/995	
	P 3562	Lot 98	2855/996	
	P 3562	Lot 99	2855/997	
	P 3562	Lot 100	2855/998	
	P 3562	Lot 101	2855/999	
	P 3562	Pt Lot 102	2855/1000	

**New Notifications and Memorials**

Subject	Purpose	Statutory Reference	Origin	Land Burdened	Benefit To	Comments
	NOTIFICATION (Hazards or Other Factors)	SEC 165 OF THE P&D ACT 2005	DOC	LOTS 1-9		PROXIMITY TO MARKET GARDEN

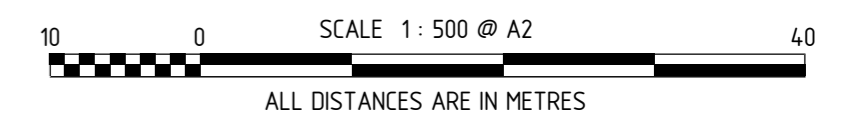
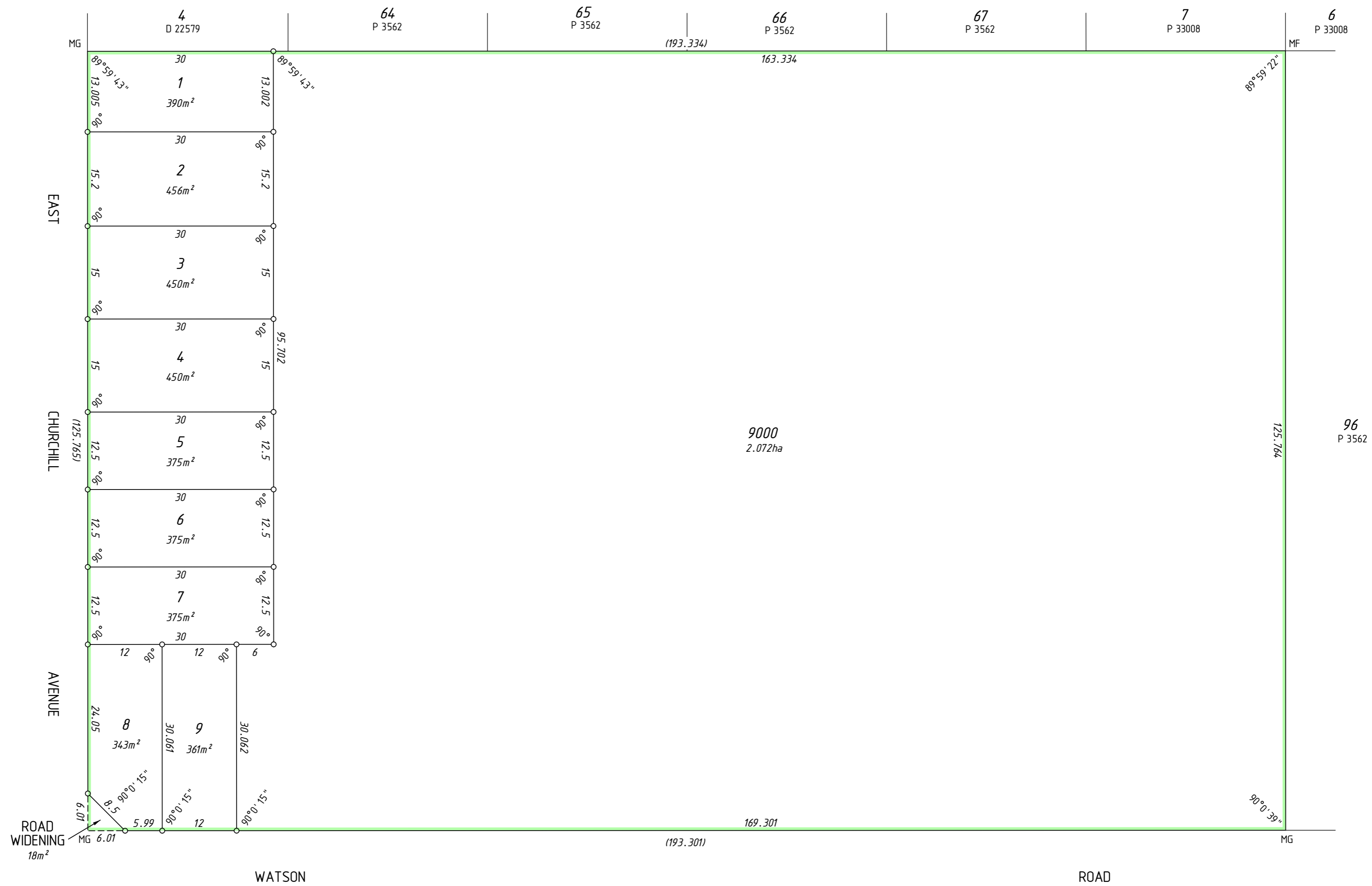

MC MULLEN NOLAN GROUP  
 PO Box 3526, Success W.A. 6964  
 Tel: (08) 6436 1599  
 Fax: (08) 6436 1500  
 Email: info@mngsurvey.com.au

MNG Ref : 101335dp-003c - Stage 1 - DP414954.CSD

ADDITIONAL SHEETS  
 SURVEY SHEET

SHEET SHEETS  
 2 OF 2

VERSION NUMBER  
 1

DEPOSITED PLAN  
 414954

THIS SURVEY SHEET WILL BE  
REPLACED BY THE SURVEY DATA



MC MULLEN NOLAN GROUP  
PO Box 3526, Success W.A. 6964  
Tel: (08) 6436 1500  
Fax: (08) 6436 1500  
Email: info@mngsurvey.com.au

MNG Ref : 101335dp-003c

VERSION NUMBER

1

DEPOSITED PLAN

414954